

# Technical Manual

# JBL LSR4328P



## SPECIFICATIONS

### SPECIFICATIONS:

- Frequency Response: +/- 1.5 dB: 50 Hz - 20 kHz  
3 dB: 43 Hz - 22 kHz  
-10 dB: 35 Hz - 32 kHz
- SPL / 1m: 106 B / 112 dB (Continuous / Peak)
- Transducers (LF, HF): 8" 438H / 1" 431 G; Self-Shielded, Neodymium Motor Structures
- Sensitivity: 96 dB / 1m (+4 dBU, -10 dBV)
- Amplification (LFF, HF): 150 w / 70 w
- Digital Processing: 24 Bit, 96 kHz
- Analog Inputs: XLR, 1/4" Balanced (+4 dBU, -10 dBV)
- Digital Inputs: AES / EBU XLR, S / PDIF RCA
- Data Connections: Harman HiQnet™ Network, USB, RMC Mic

### AURAL SWEEP TEST SPECIFICATIONS:

- A. System Aural Sweep Test: 300 mV Input, 10 Hz to 20 kHz
- B. L.F. Aural Sweep Test: 6.0 V Input, 60 Hz to 5 kHz
- C. H.F. Aural Sweep Test: 4 V Input, 5 kHz to 20 kHz

### PHYSICAL SPECIFICATIONS:

- Enclosure Dimensions: 438 mm x 267 mm x 269 mm  
(H x W x D) (17.25 in. x 10.5 in x 10.6 in)
- Net Weight (ea): 13.1 kg (29 lb)

### WARRANTY INFORMATION:

- Refer to Warranty Statement packed with each product.

## PACKAGE

Warranty 59660

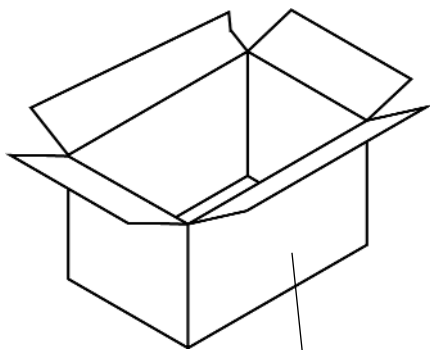

- Carton 352711-001
- Filler 352710-001
- Manual 352712-001
- PKG, Microfoam (2) 49790P



- AC Cord 120V 425-00000-00
- AC Cord 425-00000-00 (230V)

- Cable Cat 5 362098-001

## SIGNAL AC INPUT BOARD

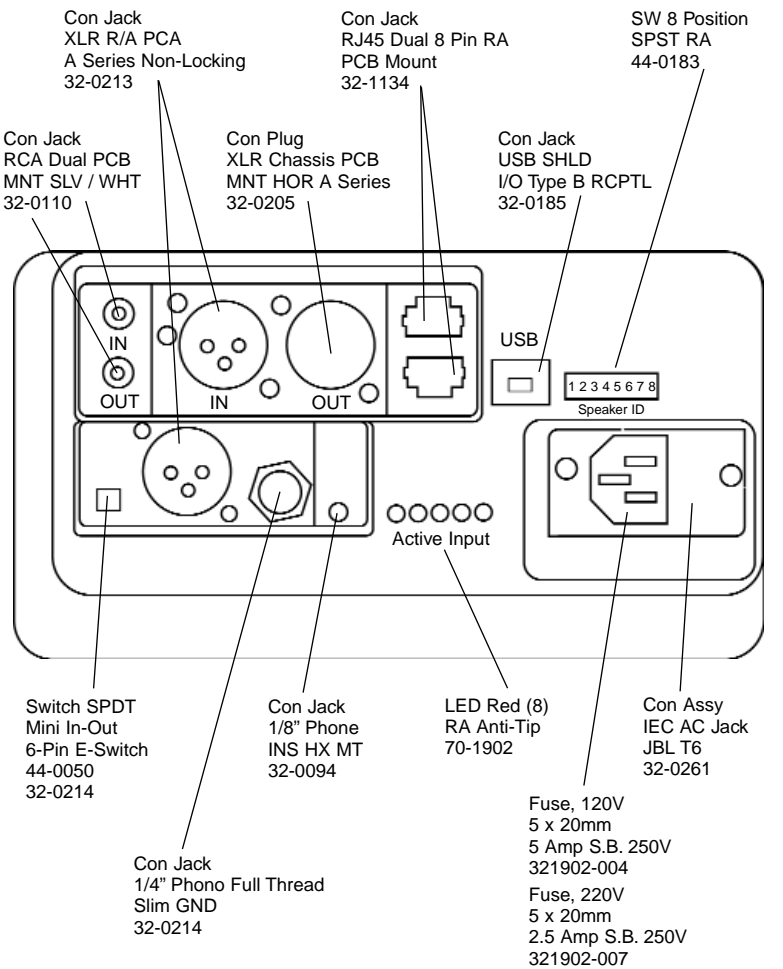

JBL LSR4328P REV D

# JBL LSR4328P

## COMPONENT EXPLODED VIEW

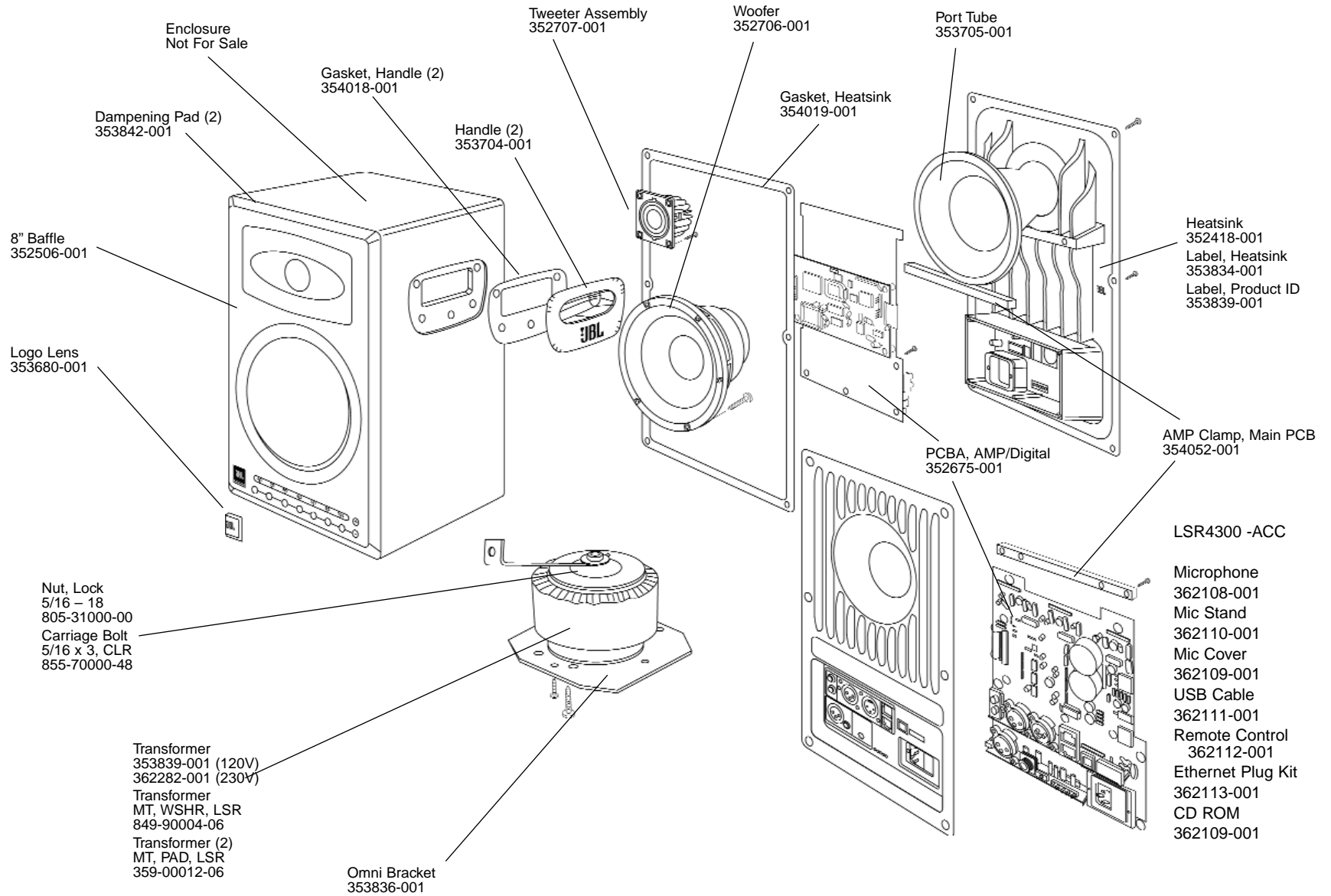

JBL LSR4328P